

# CruiseCraft IV



SLEEPING CAPACITY **14**

The *CruiseCraft IV* was introduced to our rental fleet in 2003. The most luxurious boat in the fleet, she appeals to discerning vacationers and families looking for an unparalleled experience on Shuswap Lake. One of the most innovative models ever introduced, the galley area features stainless steel appliances and a vaulted ceiling. The bridge deck has been designed to really entertain - with outdoor cooking centre, TV/DVD and CD stereo system and a hot tub of course!

## *CruiseCraft IV*

	<b>\$369,255</b>
GST	<b>\$25,848</b>
<b>TOTAL</b>	<b>\$395,103</b>



IV  
C R U I S E C R A F T



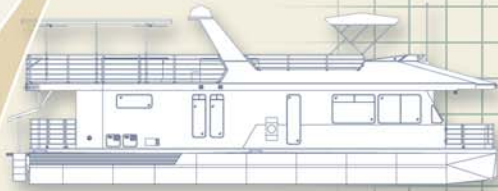

**Length** \_\_\_\_\_ 60'  
**Beam** \_\_\_\_\_ 16'  
**Weight** \_\_\_\_\_ 36,000 lb.  
**Fore Deck Length** \_\_\_\_\_ 8'  
**Aft Deck Length** \_\_\_\_\_ 9'  
**Head Room** \_\_\_\_\_ 84"  
**Draft (Pontoons)** \_\_\_\_\_ 20"  
**Bridge Clearance** \_\_\_\_\_ 20'6"

**TANKAGE**

**Fuel** \_\_\_\_\_ 230 US Gal.  
**Water** \_\_\_\_\_ 100 US Gal.  
**Holding** \_\_\_\_\_ 750 US Gal.

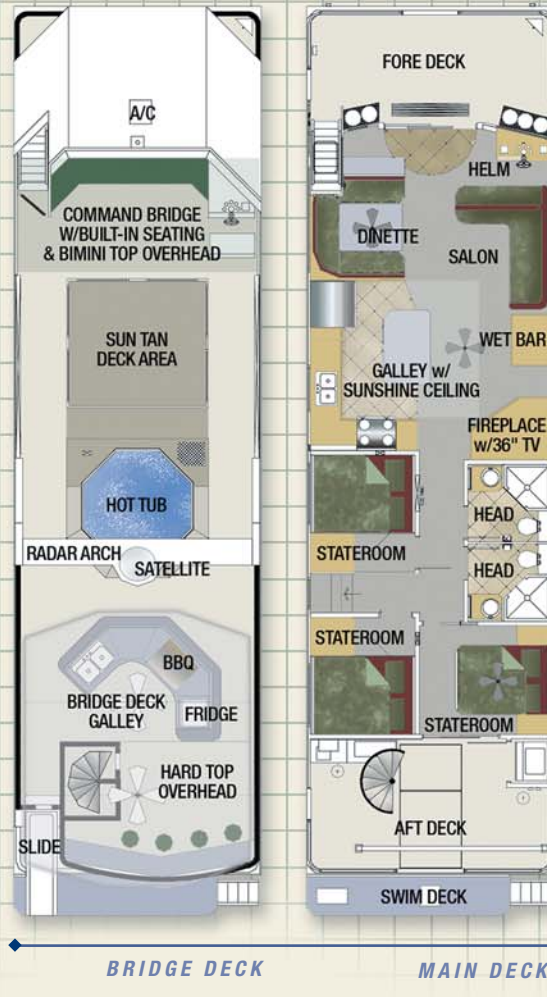

# CRUISE CRAFT IV

**SLEEPS UP TO 14 PEOPLE**

## Main Deck

- 4 Staterooms with queen beds
- 1 Stateroom with double bed
- Convert the sofa and dinette into 2 double beds
- 2 Full Baths (Sink, toilet, shower)
- Stainless Steel Appliances including 25 cu. ft. fridge/freezer, range, microwave, dishwasher and trash compactor
- Stacked washer / dryer
- Fireplace
- Salon Wet Bar
- 36" TV/CD/DVD & Home Theatre Sound Entertainment Centre in salon
- TV/VCR Combo in each state room
- Sony Playstation II

- Fish Finder & Compass
- Vaulted Ceiling in Galley
- Air Conditioning
- Twin 10 Gal. Hot Water Tanks
- Forward / Rear Access to Bridge Deck

## Bridge Deck

- Hot Tub
- Bimini Top
- Hard Top
- Entertainment Area including BBQ, double stainless steel sink, TV/DVD, CD stereo and built-in seating area.
- Suntan Area

