

# CruiseCraft III

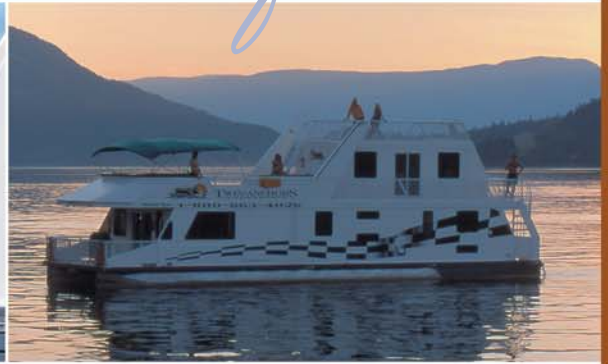

SLEEPING CAPACITY 22

The *CruiseCraft III* was introduced three seasons ago. She is the largest houseboat in our rental fleet and features five staterooms, one bunk room, two double cuddies and 2 full baths, plus a full complement of appliances. This model appeals to large groups looking for a luxurious vacation on Shuswap Lake complete with all the comforts of home.

### *CruiseCraft III*

	\$356,045
GST	\$24,923
<b>TOTAL</b>	<b>\$380,968</b>



CRUISE CRAFT III



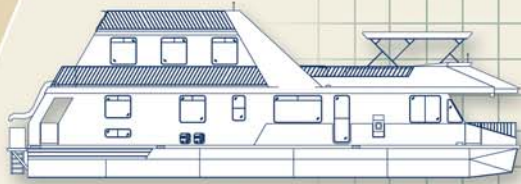

Length \_\_\_\_\_ 66'  
 Beam \_\_\_\_\_ 16'9"  
 Weight \_\_\_\_\_ 36,000 lb.  
 Fore Deck Length \_\_\_\_\_ 8'6"  
 Aft Deck Length \_\_\_\_\_ 9'  
 Head Room \_\_\_\_\_ 84"  
 Draft (Pontoons) \_\_\_\_\_ 20"  
 Bridge Clearance \_\_\_\_\_ 20'6"

**TANKAGE**

Fuel \_\_\_\_\_ 235 US Gal.  
 Water \_\_\_\_\_ 100 US Gal.  
 Holding \_\_\_\_\_ 700 US Gal.

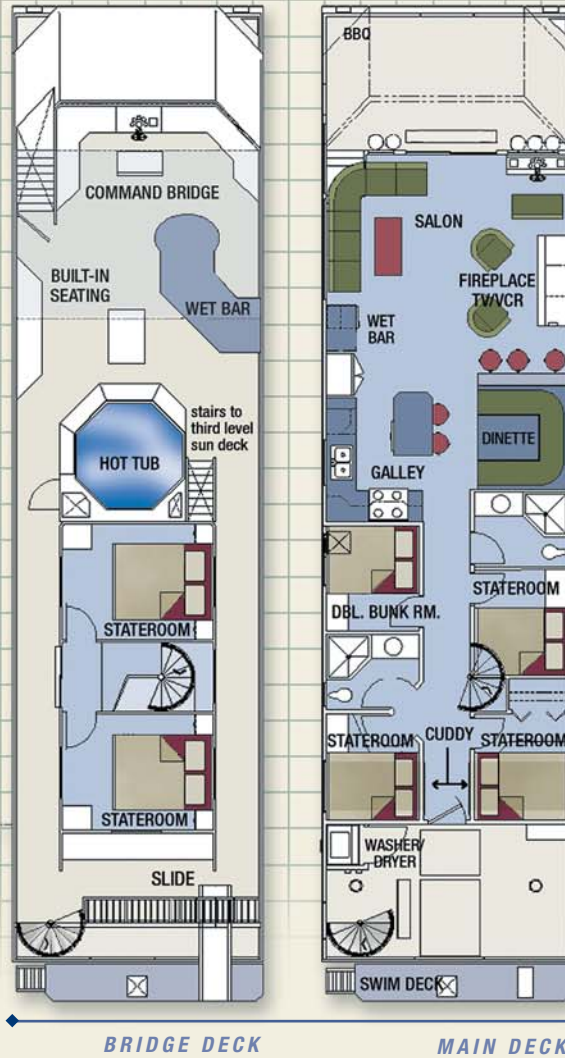

# CRUISE CRAFT III

**SLEEPS UP TO 22 PEOPLE**

## Main Deck

- 2 Staterooms with queen beds
- 3 Staterooms with double beds
- 1 Bunk Room with 2 double beds
- 2 Double Cuddies
- Convert the sofa and dinette into 2 double beds
- 2 Full Baths (Sink, toilet, shower)
- Appliances including 2.5 cu. ft. fridge/freezer, range, microwave, dishwasher and washer / dryer.
- Fireplace
- Salon Wet Bar
- 36" TV/CD/DVD & Home Theatre Sound Entertainment Centre in salon

- Sony Playstation II
- Air Conditioning
- Forward / Rear Access to Bridge Deck

## Bridge Deck

- Hot Tub
- Bimini Top
- Deluxe Wet Bar
- Full Size Stand-up Penthouse with queen beds
- Half Bath
- TV/VCR Combo in State Rooms
- Suntan Area

