



**YOUR DREAMS. OUR PASSION.**  
 CUSTOM HOUSEBOATS BY TWIN ANCHORS MARINE



A FEW OF THE RENTAL COMPANIES WE PROUDLY BUILD CUSTOM HOUSEBOATS FOR...

**CALIFORNIA**

**THE DELTA**  
 H&H Marina

**SHASTA LAKE**  
 Jones Valley Resort  
 Sugarloaf Resort  
 Lakeview Marina  
 Silverthorn Resort  
 Antlers Resort & Marina

**SIERRAS**  
 Lake McClure Marina

**GOLD COUNTRY**  
 New Melones Lake Marina

**LAKE SONOMA**  
 Lake Sonoma Marina

**OREGON**

**LAKE BILLY CHINOOK**  
 Cove Palisades Marina

**WASHINGTON**

**LAKE ROOSEVELT**  
 Dakota Columbia  
 Lake Roosevelt Resort & Marina  
 Roosevelt Recreational  
 Enterprises

**ARIZONA**

**LAKE POWELL**  
 Lake Powell Resorts & Marinas

**KENTUCKY**

**LAKE CUMBERLAND**  
 State Dock

**BRITISH COLUMBIA**

**SHUSWAP LAKE**  
 Twin Anchors Houseboats  
 Fairmont Resort Vacations

**LAKE KOOCANUSA**  
 Sunshine Houseboats



Twin Anchors Marine Manufacturing builds quality houseboats for private and commercial use. Our dedicated team of certified tradespeople, support staff and management all work toward one goal: to produce vessels of the highest quality and reliability with a parallel commitment to exemplary levels of service and customer satisfaction.

*Leading the world  
 of houseboating through  
 customer satisfaction,  
 employee commitment,  
 innovative design and  
 product excellence.*



675 OLD TOWN ROAD, PO BOX 318, SICAMOUS, BC, V0E 2V0 CANADA

1-800-558-0881 | twinanchors.com

1-800-558-0881 | twinanchors.com

*Cruise Craft*

JONES VALLEY RESORT ESCAPE

# Cruise Craft

## 5615

Custom built for Jones Valley Resort

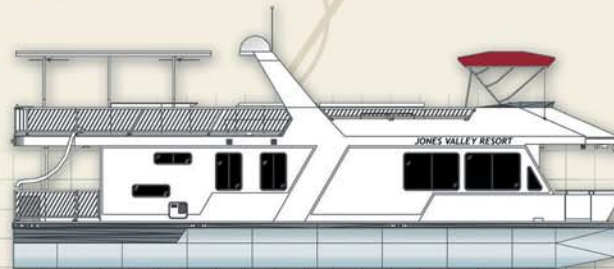

Length \_\_\_\_\_ 56'  
 Beam \_\_\_\_\_ 15'  
 Fore Deck Length \_\_\_\_\_ 8'  
 Aft Deck Length \_\_\_\_\_ 10'  
 Head Room \_\_\_\_\_ 84"

**TANKAGE**  
 Fuel \_\_\_\_\_ 230 Gal.  
 Water \_\_\_\_\_ 200 Gal.  
 Holding \_\_\_\_\_ 700 Gal.

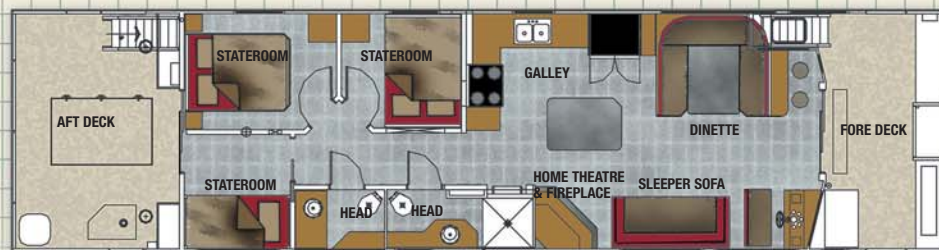

For rental information call 1-877-HOUSEBOAT (1-877-468-7326) or visit [houseboats.com](http://houseboats.com)

FOR MANUFACTURING INFO CALL 1-800-558-0881 OR VISIT [twinanchors.com](http://twinanchors.com)



# CRUISE CRAFT 5615

"ESCAPADE" FOR JONES VALLEY RESORT, SHASTA LAKE

### 3 Staterooms plus Loft

#### STRUCTURAL

- |                                   |                           |
|-----------------------------------|---------------------------|
| Command Bridge w/built-in Seating | Loft with Two Double Beds |
| Radar Arch                        | Deluxe Bridge Deck Wetbar |
| Custom 8 Person Hot Tub           | Built-in Ice Chests       |

#### RIGGING, RAILS & LADDERS

- |                              |                      |
|------------------------------|----------------------|
| Custom Powdercoated Railings | Spiral Staircase Aft |
| Waterslide                   | Side Access Forward  |
| Molded Fiberglass Hardtop    | Aft Dining Bar       |
| Bimini                       | Boarding Ramp        |

#### MECHANICAL FEATURES & OPTIONS

- |   |                      |
|---|----------------------|
| 5.0 L V8 MerCruiser w/Bravo II Outdrive | Fuel Transfer Switch |
| Dual Station Electronic Controls        | Rudder Indicator     |
| 15KW Westerbeke Generator               | Intercom             |

#### HEATING, COOLING & VENTILATION

- |                                      |                       |
|--------------------------------------|-----------------------|
| 2.5 Ton Split Unit Heat Pump         | Exhaust Fans in Heads |
| 35,000 BTU Furnace Ducted Throughout | Faux Fireplace        |

#### PLUMBING FEATURES & OPTIONS

- |                       |                             |
|-----------------------|-----------------------------|
| 3 Washdowns           | Dockside Water              |
| Aft Deck Shower       | 10 Gallon Hot Water Heaters |
| 2 Onboard Water Pumps | Stainless Accumulator Tank  |

#### ELECTRICAL FEATURES & OPTIONS

- |                         |                                     |
|-------------------------|-------------------------------------|
| 15KW Generator          | 50 Amp Shore Power                  |
| 3000 Watt Inverter      | Deluxe 110V/12V Panel               |
| 3 - 12V Start Batteries | Recessed Fluorescent Cabin Lighting |
| 12 - 6V Cabin Batteries | Rope Lighting Accents               |

#### APPLIANCES & ELECTRONICS

- |   |   |
|---|---|
| <b>Salon:</b> Digital Home Theatre System<br>CD, DVD, VCR, Satellite Receiver,<br>Surround Sound, 36" Television<br>XM Satellite Radio. | <b>Staterooms:</b> 4 - JVC 13" Combo TV/VCR   |
| <b>Bridge Deck:</b> CD Stereo System, Amp<br>Satellite Receiver, 20" TV/DVD<br>Bar Fridge, Built-in Grill                               | <b>Galley:</b> Stainless Appliances:<br>30" Range, 25 cu.ft. Refrigerator,<br>Dishwasher, Microwave, Trash<br>Compactor, Intercom Galley/Bridge<br>Blender, Coffee Maker, Toaster |

#### CABINETS & MILLWORK

- |                                      |                              |
|--------------------------------------|------------------------------|
| Solid Beech Cabinets & Interior Trim | Molded Granicoat Countertops |
| Custom Entertainment Centre Cabinet  | Wine Rack                    |
| Custom Stateroom Cabinetry           | Pull-out Pantry              |

#### CABIN FINISHING, FURNISHINGS, SAFETY

- |                       |                                |
|-----------------------|--------------------------------|
| Deluxe Sleeper Sofa   | Convertible Dinette (Sleeps 2) |
| Reversible Helm Chair | Custom Window Treatments       |