

# TITANI

## SPECIFICATIONS

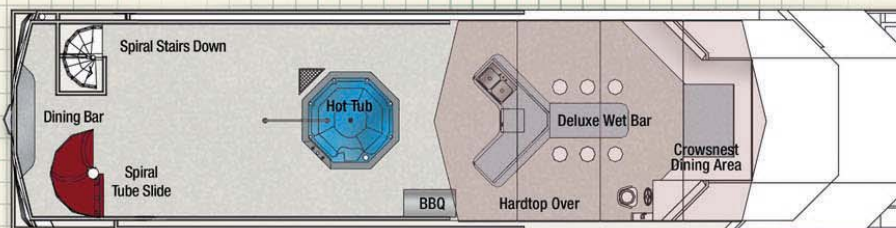

TEXAS DECK

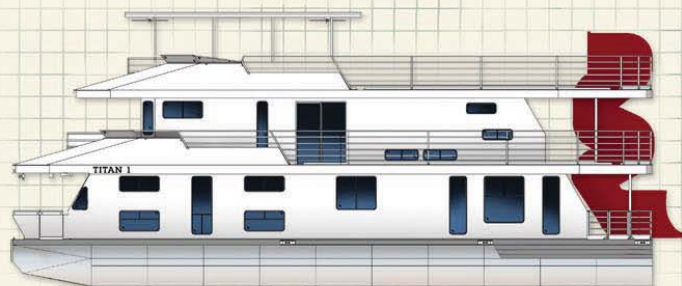
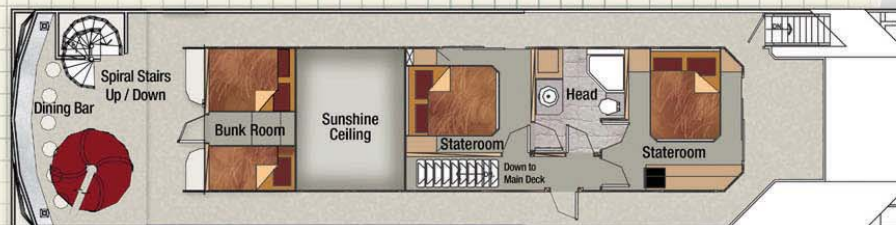
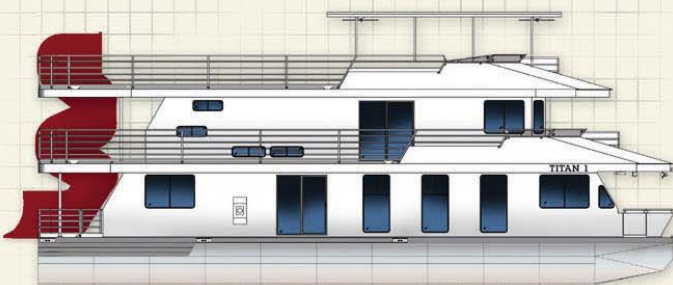

CALIFORNIA DECK

**CRUISECRAFT 6516**

Length 65'  
Beam 16'

**TANKAGE**

Fuel 230 Gal. (2 @ 115 Gal.)  
Water 110 Gal. (single tank)  
Holding 700 Gal. (2 @ 350 Gal.)  
Holding Additional 250 Gal. (center tank)  
Propane 80 lbs (2 @ 40 lbs.)

**FLOTATION**

Aluminum twin high buoyancy pontoons with sealed bulkheads 5' o.c. and 8' nose cones.

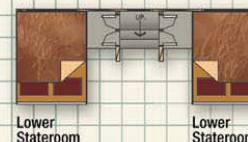

Lower Stateroom

Lower Stateroom



MAIN DECK

**STRUCTURAL**

- Texas Deck Command Bridge
- Fiberglass Engine Hatch w/gas assist hoods
- Vaulted Ceiling and Suntan Platform
- Full Height Penthouse w/ 2 staterooms and head
- 8 Person Hot Tub
- Crownst Dining Area
- Recessed Propane w/ molded fiberglass seat covers
- Two Cuddy Staterooms
- Bridge Deck Bunk Room
- Designer "Y" Wet Bar

**RAILS, LADDERS & ACCESSORIES**

- Euro Rails
- Spiral Staircase
- Custom Waterslide
- TV Cabinet on Texas Deck
- Canvas Skirting on Bridge Rails
- Retractable Boarding Ramp
- Molded Fiberglass Hardtop
- Raised Dining Bar across Fantail

**MECHANICAL FEATURES & OPTIONS**

- Merc 5.0 MPI Bravo II
- Hydraulic Steering System
- 8KW & 20KW Generator
- Electronic Controls

**HEATING & COOLING OPTIONS**

- Central Air - 4.0 Ton split unit
- Faux Fireplace
- 35,000 BTU Forced Air Furnace
- Designer Ceiling Fans - dinette & galley

**PLUMBING FEATURES & OPTIONS**

- 3 - Heads
- Double Stainless Steel Sink - galley
- Pressurized Water System
- 3 - Vanity Sinks
- 3 - Neo-Angle Showers
- Aft Deck Shower

**ELECTRICAL FEATURES & OPTIONS**

- Deluxe 110v/12v Electrical Panel w/meters
- Start Batteries 3 - 12 volt
- Custom Lighting throughout
- 2 - 3000 Watt Inverters
- Cabin Batteries 16 - 6 volt deep cycle
- Satellite Input on Bridge Deck

**APPLIANCES & ELECTRONICS**

- 25 cu.ft. Refrigerator/Freezer
- Microwave
- Trash Compactor
- Wide Screen TV & Home Theatre System
- LCD TVs w/DVD in Staterooms
- 2 - 10 Gallon Hot Water Heaters
- 30" Residential Range
- Dishwasher
- Bar Fridge & Wine Cooler
- Tracking Satellite Dish
- Serius Satellite Radio System
- Quick Connect BBQ Propane Coupling

**CABINETS & MILLWORK**

- Cabinet features: plywood countertops, toe kicks and drawer construction, raised vinyl wrap doors, European adjustable hinges, custom plastic laminate countertops.
- Staterooms w/wardrobe locker, nightstands and overhead storage locker
- Maple Cabinet Doors
- Slide-out Pantry in Galley
- Molded Granite Countertops
- Fireplace / Entertainment Center Cabinet
- Hinged Island Bed w/storage under

**CABIN FINISHING/FURNISHINGS**

- Maple casings, moldings and based
- Yacht Headliner
- Extra large convertible dinette
- Pleated Shades throughout
- Carpet and vinyl flooring throughout
- 5" Quilted Foam Mattresses
- Convertible Sofa w/storage drawers
- Rated valences and decorative side curtains

**SAFETY**

- Navigation Lights
- Ships Bell
- Compass
- Twin Trumpet Horns
- Propane/CO Detectors
- Fish Finder

*Preliminary Specifications subject to change.*

## JONES VALLEY RESORT

Shasta Lake's most luxurious houseboat rentals